



Lighting the Way for Leadership

WASA/AWSP 2023

Summer Conference

Program

Agenda at a Glance

SATURDAY, JUNE 24

7:00 a.m. – 4:00 p.m. | Pre-Conference Registration
8:00 a.m. – 4:00 p.m. | AWSP and WSPEF Board Meetings
9:00 a.m. – 12:00 p.m. | AM Pre-Conference Session
9:00 a.m. – 4:00 p.m. | Full-Day Pre-Conferences (Day 1)
10:00 a.m. – 3:00 p.m. | WASA Board Meeting
1:00 – 4:00 p.m. | PM Pre-Conference Session

SUNDAY, JUNE 25

7:00 a.m. – 1:00 p.m. | Pre-Conference Registration
9:00 a.m. – 4:00 p.m. | Full-Day Pre-Conferences (Day 2)
9:00 a.m. – 12:00 p.m. | AM Pre-Conference Sessions
1:00 – 4:00 p.m. | PM Pre-Conference Sessions
1:00 – 6:15 p.m. | Conference Registration
4:00 – 5:00 p.m. | Connection Hour for BIPOC Leaders,
hosted by WALAS, AWSP, and WASA
4:00 – 6:00 p.m. | Conference Book Store
4:00 – 6:00 p.m. | Exhibits Grand Opening and Reception
6:15 – 8:30 p.m. | Opening Keynote and Banquet
with Steve Pemberton
8:30 – 9:00 p.m. | Steve Pemberton Book Signing

MONDAY, JUNE 26

6:15 – 7:00 a.m. | A Walk in the Park with Outdoor Schools WA
7:00 a.m. – 4:30 p.m. | Conference Registration and Book Store
7:00 – 8:00 a.m. | Exhibits and Breakfast
8:15 – 9:30 a.m. | Keynote with Dr. Luis F. Cruz
9:30 – 10:00 a.m. | Exhibits and Refreshment Break
9:30 – 10:00 a.m. | Dr. Luis F. Cruz Book Signing
10:00 – 10:55 a.m. | Concurrent Session I
11:10 a.m. – 12:05 p.m. | Concurrent Session II
12:15 – 1:30 p.m. | Association Luncheons
1:30 – 1:50 p.m. | Visit Exhibits
1:50 – 2:45 p.m. | Concurrent Session III
2:45 – 3:30 p.m. | Exhibits, Dessert Social, and Prize Drawings
3:30 – 4:25 p.m. | Concurrent Session IV
4:30 – 6:00 p.m. | WASA Member President-Elect Candidates' Reception

TUESDAY, JUNE 27

6:15 – 7:00 a.m. | A Walk in the Park with Outdoor Schools WA
7:30 – 9:00 a.m. | Conference Registration
7:30 – 9:30 a.m. | Conference Book Store
7:30 – 9:30 a.m. | Exhibits and Coffee
8:30 – 9:25 a.m. | Concurrent Session V
9:30 – 11:15 a.m. | Brunch and Keynote with Janel Keating
11:15 a.m. – 12:00 p.m. | Janel Keating Book Signing
2 | WASA/AWSP SUMMER CONFERENCE 2023

Thank you to our Conference Sponsor!



College Spark Washington supports the postsecondary dreams of students and their communities through grantmaking focused on dismantling racism in the education system.

They envision an education system that encourages learners to be their authentic selves and is eager and equipped to guide them towards realizing their dreams.

College Spark began supporting access to higher education in 1978 by managing student loan programs. In 2004, College Spark reorganized as an education grantmaker and since then we have committed more than \$70 million to college readiness and degree completion programs throughout Washington state.



DOWNLOAD THE APP!

Search for "WASA/AWSP Summer Conference" in your app store, scan the QR code below with your device, or visit <https://wasa-oly.org/Summer23>.

For Apple:



For Android:



Share your photos with us! Use #WASAAWSP23

GENERAL INFORMATION

Pre-Conference Registration at the Grand Hotel:

Saturday, June 24 | 7:00 a.m. – 4:00 p.m. | GH Prefunction 5
Sunday, June 25 | 7:00 a.m. – 2:00 p.m. | GH Prefunction 5

Conference Registration at the Convention Center Riverside Lobby:

Sunday, June 25 | 1:00 – 6:15 p.m.
Monday, June 26 | 7:00 a.m. – 4:30 p.m.
Tuesday, June 27 | 7:00 – 9:30 a.m.

Name Badges

Name badges are required for entrance at all conference events.

Meeting Location Codes

GH: Grand Hotel
DT: Doubletree Hotel
CC: Convention Center

Meal Tickets

Meal tickets will be collected for all meals. Please present your ticket at the door before entering each banquet. When checking in at the conference, attendees with special dietary needs will receive an additional ticket to place by their plates to alert servers.

Clock Hours

Pre-conference clock hours will be available at the conclusion of the pre-conference session. Summer Conference clock hours will be available at the registration desk on Tuesday.

Exhibit Hall

The Exhibit Hall will be the location of the breakfast, refreshment breaks, and ice cream social. Please visit the exhibitors and thank them for their support of our associations. A directory can be found at the back of this program.
Sunday 4:00 – 6:00 p.m.
Monday 7:00 a.m. – 4:30 p.m.
Tuesday 7:30 – 9:30 a.m.

Hidden Spring Book Company

The conference book store, provided by Hidden Spring Book Company, will be located in Exhibit Hall A. Please check out the wide assortment of publications available!

Closing Brunch, Keynote, and Prize Drawing

Be sure to attend the Tuesday Closing Brunch with Janel Keating for a chance to win a prize from our drawing.

Thank you to our friends at OSPI!



Washington Office of Superintendent of
PUBLIC INSTRUCTION

FRIDAY, JUNE 23

8:00 A.M. – 3:30 P.M.

WASHINGTON STATE LEADERSHIP ACADEMY

Location: GH Prefunction 5

2:00 – 5:00 P.M.

AWSP EXECUTIVE COMMITTEE MEETING

Location: GH Redwood Boardroom

SATURDAY, JUNE 24

7:00 A.M. – 4:00 P.M.

PRE-CONFERENCE REGISTRATION

Location: GH Prefunction 5

8:00 A.M. – 4:00 P.M.

AWSP AND WSPEF BOARD MEETINGS

Location: GH Cedar Ballroom

9:00 A.M. – 4:00 P.M.

**FULL-DAY INSTRUCTIONAL AND
PRE-CONFERENCE SESSIONS (DAY ONE)**

CEL Instructional Framework Stage 1

Location: GH Meeting Room 11

Danielson Instructional Framework Stage 1

Location: GH Meeting Room 12

Marzano Instructional Framework Stage 1

Location: GH Meeting Room 10

**Increasing Teacher Effectiveness Through
Focused Conversations**

Location: GH Meeting Room 2

9:00 A.M. – 12:00 P.M.

AM PRE-CONFERENCE SESSION

**UDLize Your Leadership to Transform
Teacher Practice**

Location: Maple Ballroom

1:00 – 4:00 P.M.

PM PRE-CONFERENCE SESSION

**Leveraging the Strategic Plan for
Increased Collaboration, Coherence, and
Improved Student Outcomes**

Location: Maple Ballroom

10:00 A.M. – 3:00 P.M.

WASA BOARD MEETING

Location: GH Birch Boardroom

SUNDAY, JUNE 25

7:00 A.M. (TOURNAMENT AT 8:00 A.M.)

GOLF TOURNAMENT

Location: Liberty Lake Golf Course

Sponsored by:

Beresford Company,

McKinstry,

OAC,

and Piper Sandler



PIPER | SANDLER

7:00 A.M. – 1:00 P.M.

PRE-CONFERENCE REGISTRATION

Location: GH Prefunction 5

9:00 A.M. – 4:00 P.M.

FULL-DAY INSTRUCTIONAL AND AWSP LEADERSHIP FRAMEWORK PRE-CONFERENCE SESSIONS (DAY TWO)

CEL Instructional Framework Stage 1

Location: GH Meeting Room 11

Danielson Instructional Framework Stage 1

Location: GH Meeting Room 12

Marzano Instructional Framework Stage 1

Location: GH Meeting Room 10

Increasing Teacher Effectiveness Through Focused Conversations

Location: GH Meeting Room 2

Becky Lee, Principal, North Thurston PS

Anzara Miller, Director of Leadership and Development, CSTP

Teacher learning links directly to student learning, and as what we know about learning changes, how do you as an administrator support teacher growth through conversation? Come to this two-day session where you will learn strategies and skills to grow your skill set to improve your efficacy in supporting teacher growth. Participants will use tools and templates to learn and practice strategies and skills, view model conversations, and leave with tangible resources to support conversations with teachers.

Fostering Collective Efficacy to Maximize Impact

Location: Cedar Ballroom

Peter DeWitt, Author, Education Coach

Jenni Donohoo, Author, Facilitator

Schools face many barriers in their pursuit to foster student growth. What is needed to overcome those barriers is the collaborative effort of leaders and teachers. Success in schools lies in the strength of believing that through their combined efforts, principals and their faculty can accomplish great things for the learning lives of students. Collective efficacy is the shared conviction that educators make a significant contribution in raising student achievement. During this full day session, we will learn about the collective efficacy research and demonstrate practical ways leaders and teachers can strengthen efficacy in their schools and classrooms.

9:00 A.M. – 12:00 P.M.

MORNING PRE-CONFERENCE SESSION

Everything I Wish My Administration Knew About Brilliant Teaching

Location: Meeting Room 1

Dr. Yemi Stenbridge, Educational Consultant

In this session, the argument will be made that the teaching necessary for closing equity gaps in public schools requires teaching that is culturally responsive, rigorous, and designed with the local needs and assets of students and also the contexts for learning in mind. This kind of teaching can be called "brilliant" because it illuminates and projects light on the possibilities for engaged learning and life-changing understandings. This is an easy argument to make to teachers, and many administrators agree in principle to this statement, as well. But too many teachers see the systems (i.e. policy environment) to be restrictive of the very types of pedagogy to which brilliant teaching aspires. This session will highlight some of the issues that teachers face in their efforts to do the work necessary to provide more equitable and meaningful opportunities to all of their students in the classroom.

Culturally Relevant and Sustaining Formative Assessment for English Learners

Location: GH Maple Ballroom

Dr. Paul Bloomberg, Founder, The Core Collaborative

This session will challenge educators to give voice to the students and families they serve and guide them on a path towards providing all students with access to Culturally Responsive and Sustaining Education (CRSE) and Formative Assessment. When it comes to advancing CRS formative assessment, it is important to recognize that we have historically failed to partner with English Learners (EL) and their families to formatively assess language acquisition, identify language acquisition levels, set goals around language acquisition, and celebrate gains. We will explore strategies to begin this process as well as to build the critical consciousness of our ELs so that they are empowered to own their learning and create change in their lives, thereby disrupting the status quo. It is time to "Amplify the Voice" of all students and families through CRS formative assessment.

SUNDAY, JUNE 25

1:00 – 4:00 P.M.

AFTERNOON PRE-CONFERENCE SESSION

Advancing Student Agency Through Teacher Collaboration

Location: Maple Ballroom

Dr. Paul Bloomberg, Founder, The Core Collaborative
Rachel Fairchild, Partner Consultant, The Core Collaborative

There's no universal affection in this role! Do you have the courage to move beyond managing to leading learning and developing the leadership capacity in others? This session will focus on the critical leadership behaviors of the principal, assistant principal, and their relationship with the team leaders when building a collaborative culture and a school-wide focus on learning both for students and the adults who serve them.

1:00 – 3:30 P.M.

WASA LEGISLATION AND FINANCE COMMITTEE MEETING

Location: GH Meeting Room 4

2:00 – 4:00 P.M.

ERNN BOARD

Location: GH Redwood Boardroom

4:00 – 5:00 P.M.

SIRS MEETING

Location: GH Meeting Room 4

1:00 – 6:15 P.M.

CONFERENCE REGISTRATION

Location: CC Riverside Lobby

4:00 – 5:00 P.M.

CONNECTION HOUR FOR BIPOC LEADERS HOSTED BY WALAS, AWSP, AND WASA

Location: 402C

4:00 – 6:00 P.M.

CONFERENCE BOOK STORE

Location: CC Exhibit Hall A

Brought to you by *Hidden Spring Book Company*

4:00 – 6:00 P.M.

EXHIBITS GRAND OPENING AND RECEPTION

Location: CC Exhibit Hall A

6:15 – 8:30 P.M.

OPENING KEYNOTE & BANQUET

Location: CC Exhibit Hall C

OSPI Update

Chris Reykdal

Superintendent of Public Instruction



Washington Office of Superintendent of
PUBLIC INSTRUCTION



Curriculum Associates®



Steve Pemberton

*Chief Human Resources Officer, Workhuman,
and Best Selling Author, A Chance in the World*



Considered one of America's most inspiring business and HR leaders, Steve Pemberton's triumphant life story is about defying seemingly insurmountable beginnings as a child orphaned into foster care. Born to a mother who was in the middle of a losing battle with alcoholism, it was said about Steve that "this little boy doesn't have a chance in the world." His inherited circumstances, handed down from one generation to the next, was not the fault of Steve, but he still looked at it as his responsibility. That determination to better his life was met by the kindness of everyday citizens who affirmed that fight. As told in the major motion picture and acclaimed, best-selling memoir, *A Chance in the World*, adversity only fueled his desire to become a man of resilience, determination and vision. Steve went on to find success as a corporate executive, innovative diversity and inclusion thought leader, visionary youth advocate, and acclaimed speaker devoted to inspiring and helping others. Steve's keynotes, like his life story, amplify his highly motivational messages: Believe in your dreams, rise above obstacles, create opportunities for others, and most of all, persevere.

8:30 – 9:00 P.M.

STEVE PEMBERTON BOOK SIGNING

Location: CC Riverside Lobby

MONDAY, JUNE 26

6:15 – 7:00 A.M.

CONNECT AND REFLECT: A WALK IN THE PARK WITH OUTDOOR SCHOOLS WA

Location: Riverfront Park

Join Outdoor Schools WA for a morning of self-care, connection, and reflection as we walk through the park. There will be prizes!



6:45 – 8:00 A.M.

WASA SMALL SCHOOLS COMMITTEE AND RURAL ED. MEETING

Location: GH Meeting Room 11

7:00 – 8:00 A.M.

EXHIBITS AND CONTINENTAL BREAKFAST

Location: CC Exhibit Hall A

7:00 A.M. – 4:30 P.M.

CONFERENCE REGISTRATION, BOOK STORE, AND EXHIBIT HALL

Registration Location: CC Riverside Lobby

Book Store Location: CC Exhibit Hall A

Book store brought to you by *Hidden Spring Book Company*

8:15 – 9:30 A.M.

KEYNOTE SESSION WITH LUIS F. CRUZ

Location: CC Exhibit Hall C

Keynote: Dr. Luis F. Cruz

Author, Time for Change, and Educator

Luis F. Cruz, PhD, is former principal of Baldwin Park High School, located east of Los Angeles, California. He has been a teacher and administrator at the elementary, middle, and high school levels. Dr. Cruz presents on methods from the best-selling book *Time for Change* by Luis F. Cruz and Anthony Muhammad. In 2007, Dr. Cruz led a collective effort to secure a \$250,000 grant for Baldwin Park from the California Academic Partnership Program for the purpose of effectively utilizing “courageous leadership” to promote a more equitable and effective organization.



Sponsored by:



WASHINGTON STATE
ALLIANCE OF YMCAS

9:30 – 10:00 A.M.

LUIS F. CRUZ BOOK SIGNING

Location: CC Exhibit Hall A

9:30 – 10:00 A.M.

EXHIBITS AND REFRESHMENT BREAK

Location: CC Exhibit Hall A

9:45 – 11:00 A.M.

WCEAP MEETING

Location: GH Meeting Room 10

10:00 – 10:55 A.M.

CONCURRENT SESSION I

This Coaching Light of Mine, I’m Gonna Let It Shine!

DT Parkside

Our goal is to provide an education system that is engaging, effective and equitable for all students. Instructional research shows us that students and adults in our systems need relationships, hope, connection, a culture of learning that meets individual needs, and social emotional support. Instructional coaches are partners that guide teachers to the highest levels of best practice implementation. Coaches are change agents that light the way to collective efficacy in schools and districts.

Jill Massa, Director of Teaching and Learning, Warden SD

Strand: Academic Success

Audience: All

Using AI to Make Your Life Easier

300A

Discover the power of Artificial Intelligence (AI) in this interactive session designed specifically for eduleaders like you. We will explore how AI technologies can revolutionize the way you work, saving you time and effort while improving outcomes for your school or district. We will guide you through practical applications of AI in education leadership, focusing on key areas such as data analysis, decision-making, and administrative tasks.

Jethro Jones, Founder, Transformative Principal

Strand: Innovation

Audience: All

Culturally Responsive Formative Assessment for Student Growth Goals: What, Why, How

300B

Participants will learn how the revised Student Growth Goals (SGG) support culturally responsive formative assessment as a part of classroom assessment. Participants will be connected with resources to learn what culturally responsive formative

MONDAY, JUNE 26

assessment is: why it is important and what it looks and sounds like in classrooms. They will explore how they can use their leadership roles to promote culturally responsive formative assessment through the SGG process. Participants will have the opportunity to reflect and discuss their observations and ask questions.

Katie Taylor, Director of Educator Effectiveness Office, OSPI
Serena O'Neill, Mathematics Assessment Specialist, OSPI
Maja Wilson, ELA Assessment Specialist, OSPI

Strand: Academic Success

Audience: All

Growing, Supporting, and Sustaining Your School Leaders

300C

Worried about supporting and keeping your principals and assistant principals? Looking for resources to help you engage leaders in ongoing intentional professional growth conversations? Roles and expectations placed on school leaders continue to expand. We must rethink our systems of support. Come engage with the AWSP Team and your colleagues around powerful resources to help you grow, support, and sustain your school leaders. Be the first to book us for your August district leadership days!

Scott Seaman, Executive Director, AWSP
Gina Yonts, Associate Director, AWSP
Scott Friedman, Associate Director, AWSP

Strand: Culture

Audience: All

Can You Hear Me Now? The Building Blocks of Effective, Inclusive Communication

300D

Conquer clear, concise communication in this breakout session. We know communication can be challenging, and great culture and climate can't exist without great communication. Learn how to be a more effective, efficient, and inclusive communicator. AWSP Communications Director David Morrill will leave you with tips, tools, and takeaways to break down barriers and make your communication more consistent and clear.

David Morrill, Communications Director, AWSP

Strand: Culture

Audience: All

AWSP Leaders of Color Network

302A

AWSP's Leaders of Color Network strives to create a safe space for black and brown school administrators by providing opportunities for members to build collegial relationships, create coalitions, develop a sense of belonging, and support,

sustain, connect, and heal. This session is for leaders of color, by leaders of color where participants will be introduced to the School Leader Framework and School Leader Paradigm which can help provide self-advocacy and opportunities to take ownership of your leadership growth and advancement. In addition, participants will learn about how to get involved and be a part of increasing the level of representation and voice of leaders of color in the AWSP organization, as well as become more informed of advocacy and resources available to support.

Kamrica Ary-Turner, Associate Director, AWSP

Strand: Culture

Audience: Principals, Asst. Principals

When Data Meets Determination: Leadership Moves to Increase Student Belonging and Inclusion

302B

Being "All In!" requires an equitable system purposefully designed to see and support all students. In this session, we will share how North Kitsap School District, at both the district and school level, is breaking down systemic barriers and using academic; social and emotional; and climate and culture data to build an MTSS system that creates a sense of safety and belonging, is inclusive, and provides equitable access to support.

Beth Bourque, Assistant Director of Inclusive Education, North Kitsap SD

Jeremy Sullivan, Director of Instructional Technology Integration, North Kitsap SD

Strand: Belonging & Inclusion

Audience: All

Become a Next Level Leader!

303A

Come to this session and learn about the launch of Washington State's Premier Leadership Academy: Next Level Leaders (NLL). This is dedicated to preparing leaders to conquer complex challenges through the development of a two-year learning community. NLL is designed to focus on individual and system leadership behaviors and actions essential for success in our rapidly changing educational environment. The academy is committed to assisting educational administrators to thrive in their role.

Ashley Barker, Program Coordinator, Next Level Leaders
Jenni Donohoo, NLL Advisor & Program Evaluator
Peter DeWitt, NLL Advisor & Program Evaluator
Mike Nelson, Assistant Executive Director, WASA
Kim Fry, Assistant Executive Director, WASA

Strand: Innovation

Audience: All

MONDAY, JUNE 26

The Value of Work

303B

Join OSPI staff to learn about the progress of the Superintendent's rules process intended to provide high school students with the opportunity to earn elective credit toward graduation through verified paid work experience. Attendees will also discuss various programs and policies that further align the educational system with approaches that are student-centered.

Becky Wallace, Assistant Superintendent of Secondary Education and Pathway Preparation, OSPI

Jill Diehl, Lead CTE Program Supervisor, OSPI

Strand: Academic Success

Audience: All

Eliminating the "Cracks": Identifying and Supporting Student Needs

401A

In 2020, the Center for Educational Effectiveness developed the EESTM-Student Universal Wellness Screener, a tool now used in Washington and across the country. The Port Angeles SD implemented the screener in 2021 to better identify student needs around academic, social, emotional, and belongingness support. Port Angeles district leadership will share how screener data was integrated into their MTSS process to better target and align student supports.

Erich Bolz, VP of Research and District Engagement, The Center for Educational Effectiveness

Martin Brewer, Superintendent, Port Angeles SD

Michelle Olsen, Assistant Superintendent, Port Angeles SD

Rhonda Kromm, Principal, Jefferson Elementary, Port Angeles SD

Strand: Belonging & Inclusion

Audience: All

All Roads Lead to Agency and Dignity: Equitable Foundations to Strategic Leadership

401B

This session will offer a research-based "game changer" that inspired our district to examine its core practices in instruction, intervention, and professional growth—agency and dignity. We will discuss specific leadership practices that disrupt inequitable and ineffective practices as well as innovative steps we have taken to operationalize a district-wide strategic plan and school improvement goals centered on equitable outcomes for students with a foundational core of dignity and agency.

Aaron Lee, Executive Director for Equity and Student Outcomes, Orting SD

Edward Hatzenbeler, Superintendent, Orting SD

Cliff Fries, Principal, Orting High School

Strand: Systems

Audience: Superintendents, Principals, Asst. Principals, Central Office, Admin. Interns

Effectively Integrating School Improvement, MTSS, and Student Support

401C

Together, this team will share how these initiatives can collectively support the continuous improvement cycle. In addition, they will provide practical examples of their work and how intentional cultivation of common elements and outcomes can result in more coherent building and district success in supporting the whole child.

Sandy Gessner-Crabtree, Senior Strategy Officer for Educational Equity, OESD 114

Mona Johnson, Executive Director Systems Pathways, OESD 114

Kristin Schutte, Executive Director—Student Services, OESD 114

Strand: Academic Success

Audience: All

A Decade of Growing Teacher Leaders: Fellows, Fellows, Fellows

402A

Cultivating homegrown leadership can offer your district new opportunities to grow leaders from within and retain teachers as they connect with others, strengthen content knowledge, and build capacity for equitable teaching practices to improve outcomes for all your students. Learn how the Fellows program aligns and supports the AWSP Leadership Framework. Discover the benefits of having Fellows in your district as they learn and grow then implement action plans to support your local goals.

Michael Nerland, Assistant Superintendent for Teaching and Learning, ESD 112

Jack Arend, Deputy Director, AWSP

Jennifer Ireland, Regional Literacy Coordinator and TPEP Lead, ESD 101

Ellen Ebert, Director of Secondary Content Integration, OSPI

Kristin Monson, P-3 Early Learning Professional Development Coordinator, ESD 101

Strand: Academic Success

Audience: All

Bargaining in 2023!

402B

What's happening at bargaining tables around the state? This session will examine the current language and fiscal issues being brought to the table by labor to address changes from the Legislature and local priorities. Bargaining has become a marathon activity that affects leadership and labor alike. Even though we'd like a break, there is another round of bargaining

MONDAY, JUNE 26

coming (or already started), and it's time to get ready! Join your peers in learning and discussing the issues at hand.

Warren Hopkins, Executive Director, ERNN

Strand: Systems & Operations

Audience: Superintendents, Central Office

The Promotion of 'Third Spaces' As My Way to Meet Basic Social And Emotional Needs of Students

402C

In light of the national reported mental crisis, and the limited number of resources provided, educators may have a unique opportunity to connect students with community resources that are germane to student, families, and community experiences.

Oscar Harris, Chief Family and Community Engagement Officer, Spokane PS

Strand: Innovation

Audience: All

11:10 A.M. – 12:05 P.M.

CONCURRENT SESSION II

Building a Student Support Ecosystem Through After School Enrichment

DT Parkside

All students need a system of support for their physical, mental, social, and academic wellbeing. This session will explore how high-quality enrichment programs can enable schools to become dynamic community hubs that engage families and allow students to thrive inside and outside the classroom.

Kate Vincent, Associate Partnership Manager, Right At School
Kelley Boynton, Executive Director for Elementary Schools, Bethel SD

Strand: Belonging & Inclusion

Audience: Superintendents, Central Office

Using AI To Make Your Life Easier

300A

Discover the power of Artificial Intelligence (AI) in this interactive session designed specifically for eduleaders like you. We will explore how AI technologies can revolutionize the way you work, saving you time and effort while improving outcomes for your school or district. We will guide you through practical applications of AI in education leadership, focusing on key areas such as data analysis, decision-making, and administrative tasks.

Jethro Jones, Founder, Transformative Principal

Strand: Innovation

Audience: All

Student-Centered Strategic Planning

300B

This dynamic and interactive session will outline the key actions district leaders take when creating a living, breathing strategic plan that positions student goals at the center, garners wide-spread buy-in, and is a catalyst for school improvement. Participants will walk away with real examples and insights from district leaders who are leading this work.

Tammy Campbell, CEO, The Scholar First, Former Superintendent
Nik Bergman, Superintendent, Quincy SD

Strand: Systems & Operations

Audience: All

Supporting Children with the Highest Behavioral Needs

300C

Schools are overwhelmed with students who need intensive social and behavioral instruction. They may lack the resources to meet the level of support needed for staff, students and families. Supported by OSPI, Moving All to Success & Health (MASH) provides equitable access to behavioral, mental, social, and academic support to students who historically have been under served due to lack of community and school resources.

Darcy Johnson, Associate Director of Student Success and Learning, North Central ESD

Anna Troutman, Program Coordinator, BCBA/ MASH

Strand: Belonging & Inclusion

Audience: All

Creating a Community of Belonging through Inclusive Mission and Vision and TIER 1 Foundations

300D

WA (IPP) Demonstration Sites Project highlights how schools are engaging transformational learning for visitors and sharing their own growth. Ruby Bridges Elementary opened remotely during the pandemic. From its inception, the commitment to equity and social justice has built a community of belonging. Ruby Bridges showcases inclusive mission and visioning and tier 1 instruction through UDL, collaboration, and master schedule. Ruby Bridges exemplifies revisioning school systems where everyone is a learner, a leader, and belongs.

Cathi Davis, Principal, Ruby Bridges Elementary, Northshore SD
RinaMarie Leon-Guerrero, IPP Demonstration Sites Project Lead, UW Haring Center

Cassie Martin, Executive Director Special Education, OSPI
Christina Nowak, IPP Demo Sites Project Inclusion Specialist, UW Haring Center

Strand: Belonging & Inclusion

Audience: Principals, Elem. Asst. Principals

MONDAY, JUNE 26

From Listening and Learning to Strategic Action: Using Street Data to Inform Strategic Planning

302A

Highline PS has committed to understanding the experiences of students, staff, and families in order to deliver on our promise that every student is known by name, strength, and need and graduates prepared for the future they choose. Informed by the book, *Street Data*, by Shane Safir and Jamila Dugan, this presentation will overview our process and learning in service of strategic planning and prioritization. We will include the perspectives of school board directors, our superintendent, students, and central office leaders in order to illustrate the governance, system, and department experience of utilizing street level data to inform our future efforts.

Ivan Duran, Superintendent, Highline PS

Carrie Howell, School Board Director, Highline PS

Erinn Bennett, Chief of Staff, Highline PS

Jennifer Reinig, Chief Academic Officer, Highline PS

Strand: Innovation

Audience: Superintendents, Central Office

What's Race Got to Do With it?

302B

What are you doing as a system to retain the best and brightest BIPOC leaders? This is a conversation about moving beyond just recruitment into retention. Our time together will begin to explore ways you can support BIPOC leaders, so they want to stay and contribute to your school communities.

Jamila Gordon, Assistant Principal, Shoreline PS

Maria Serka, Assistant Principal, Einstein Middle School, Shoreline PS

Strand: Belonging & Inclusion

Audience: All

Successful Transition Planning for Incoming Administrators

303A

Incoming administrators face unique challenges as they start their new position. This presentation will focus on strategies and practices incoming administrators may use to ensure a successful transition. The presentation will focus on 1. Building positive relationships with school boards, staff, students, parents, and community. 2. Communication and collaboration. 3. Connecting with mentors and colleagues. 4. Creating/Enhancing the climate and culture. 5. Improving student achievement.

Randy Russell, Superintendent, Freeman SD

Brian Talbott, Superintendent, East Valley SD

Lisa Phelan, Principal/Asst. Superintendent, Freeman SD

Strand: Effective Systems

Audience: All

Maximum Impact: How Learning at Outdoor School Supports and Enhances Classroom Learning and Culture

303B

All of Washington's kids deserve a week in nature, but have you ever asked yourself, "Isn't outdoor school just going to camp during school?" Join us to explore what guides learning experiences at outdoor school and how standards-aligned teaching and learning in nature impact academic and social success in classrooms.

Shelley Barker, Director of School Engagement, Outdoor Schools WA

Roberta McFarland, Senior Advisor, Outdoor Schools WA

Cortney Suderman, Administrative Coordinator, Outdoor Schools WA

Greg Barker, Managing Director, Washington School Principals Education Foundation (WSPEF), AWSP

Strand: Academic Success

Audience: Principals, Elem. Asst. Principals, Superintendents, Central Office

How and Why Dual Language Can Transform Schools

401A

Washington state is leading the way in expanding dual language programs that build on the assets our multilingual students bring. Join us in this session to learn about the research, benefits, challenges, and rewards of starting a dual language program for students, families, staff, and communities. We will share success stories and answer questions about how and why dual language can transform schools and how you can get started.

Kristin Percy Calaff, Director of Multilingual Education, OSPI

Rob Darling, Deputy Superintendent, Yakima SD

Strand: Innovation

Audience: All

Addressing Equity of Access in EdTech for All Districts

401B

This presentation will focus on state-wide team building to accomplish the funding and support of statewide initiatives. This presentation will also focus on how to utilize teams and assets in a remote model to achieve a desired outcome using data and constant assessment. Past failures and pitfalls will be discussed as well as future goals and how we plan to achieve them.

Travis Rush, TechED Lead, AESD

Bre Urness-Straight, Director of Educational Technology, OSPI

Strand: Academic Success

Audience: All

MONDAY, JUNE 26

Teaming: Your Anchor for MTSS

401C

Without strong teaming, your MTSS efforts will be adrift. The MTSS team is a school-based, proactive team that anchors MTSS structures. Please join previous school and district administrators currently supporting WA state MTSS scale-up efforts as Regional Implementation Coaches as they address key elements of building and leading healthy teams, defining team functions, and exploring possible barriers. Leave with tactical knowledge and strategies you can utilize to put the wind back in your teaming sails!

Sandy Gessner-Crabtree, Senior Strategy Officer for Educational Equity, OESD 114

Tori Hazelton, Regional MTSS Implementation Specialist, Puget Sound ESD

Solina Adelson-Journey, Regional MTSS Implementation Coach, ESD 112

Strand: Effective Systems

Audience: All

Strategies for Creating a Collaborative, Effective Board Superintendent Team That Supports Success for Students

402A

Research shows that the works of school boards make a difference for the outcomes of students, both for better or for worse. Hear what this research from WSSDA says about the impact of school boards, and learn from experienced superintendents about strategies to harness the power of an effective, collaborative board-superintendent team.

Tricia Lubach, Director of Leadership Development, WSSDA

Michelle Whitney, Superintendent, Pasco SD

Adam Swinyard, Superintendent, Spokane PS

John Boyd, Superintendent, Evergreen PS

Strand: Effective Teams

Audience: Superintendents

Literacy Instruction in MTSS: Connecting Dyslexia Legislation and MTSS

402B

Washington state dyslexia law (SB 6162) requires schools to utilize MTSS to screen all K-2 students for indications of or areas of weakness associated with dyslexia, provide necessary interventions and supports, and communicate with families and caregivers. This session will provide clarification of the law, an overview of the recommendations for supporting all K-2 learners in literacy development, and next steps we are taking at OSPI to support educators.

Alicia Roberts Frank, Regional Administrator for Special Programs/ Dyslexia Specialist, Capital Region ESD 113

Rebecca Estock, MTSS Implementation Program Supervisor, OSPI

Strand: Academic Success

Audience: All

Lessons Learned Passing Levies In The Current Political Environment!

402C

The Bethel SD recently passed a Replacement Educational Programs and Operations Levy and a Capital Projects Technology Levy. This session will provide lessons and insights learned by the district after failing the first time. It will focus on strategic models and specific goals that have teams working smarter not harder to support levy efforts. Using these models, the district saw triple the parent turnout and twice as many yes votes.

Paul Marquardt, Executive Director of Operations, Bethel Schools

Strand: Systems & Operations

Audience: Superintendents, Central Office

12:15 – 1:30 P.M.

ASSOCIATION LUNCHEONS

AWSP School Leader Celebration

Annalee Braley Award & AWSP President's Award

Location: Exhibit Hall C

Special Guests: Dan Habib and Sam Habib

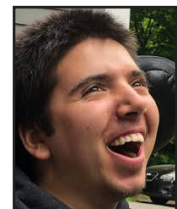

MONDAY, JUNE 26

12:15 – 1:30 P.M.

ASSOCIATION LUNCHEONS (Continued)

WASA Awards Luncheon

Location: Exhibit Hall B1

WASA Luncheon co-sponsored by:



BARBARA MERTENS LEGACY AWARD PRESENTATION

Award sponsored by:



DOYLE E. WINTER SCHOLARSHIP AWARD PRESENTATION

Award sponsored by:

PIPER | SANDLER

ROBERT J. HANDY AWARD PRESENTATION

Award sponsored by:



1:50 – 2:45 P.M.

CONCURRENT SESSION III

My Disability Roadmap

300A

Join International Film Directors Sam and Daniel Habib for a sneak peak of their upcoming feature-length film! Dan and Samuel have been contributors to the WA State Inclusionary Practices Project and are helping school and district leaders learn more about how people with disabilities navigate the path from K-12 schooling to work, college, relationships, and moving out of their family home! Their film follows Samuel Habib, a young man with complex disabilities, as he seeks out wisdom from a diverse mix of remarkable people across the country! This is the story every school leader needs to hear to help them support ALL students in their school communities.

Dan Habib, International Film Director

Samuel Habib, International Film Director

Strand: Belonging & Inclusion

Audience: All

Illuminating The Way For Student Growth — Leadership Practices For Engaging The Revised Student Growth Goals With Teachers

300B

Participants will learn from a modeled Student Growth Goal conversation and have opportunities to engage in practice in planning around using the tools and resources available to build their knowledge and skill set for implementing the revised, final Student Growth Goals in ways that impact teacher practice and student growth.

Katie Taylor, Director Educator Effectiveness Office, OSPI

Mark Gardner, Teacher, Camas SD

Ann Gray, Associate Director, Educator Effectiveness Office, OSPI

Strand: Academic Success

Audience: All

How Districts and School Leaders Can Collaborate to Support Student Behavior Post-COVID

300C

This case study describes how school leaders, district leaders, and others can align resources mid-year to support behavioral needs among students and staff post-COVID. This session will describe a specific scenario and outline the benefits of an agile, responsive, and collaborative system during challenging circumstances.

Deborah Rumbaugh, Superintendent, Stanwood-Camano SD

Melissa Robertson, Director of Special Education, Stanwood-Camano SD

Jennifer Allen, Principal, Twin City Elementary, Stanwood-Camano SD

MONDAY, JUNE 26

Tim Dickinson, Principal, Elger Bay Elementary, Stanwood-Camano SD

Strand: Culture

Audience: Superintendents, Principals, Asst. Principals, Central Office

How Inclusionary Practices, Equitable Grading, and Course Flexibility Support Every Learner

300D

This session focuses on actionable practices and strategies to increase engagement and course completion to prepare all students for their post-secondary goals. Participants will learn from secondary school demonstration site for the Inclusionary Practices Project. Discussions will include reframing existing myths about learning and highlighting strategies for students to engage and meaningfully progress in meeting required learning standards. The session will provide recommendations and resources to enhance practices around course flexibility and equitable grading practices.

Alexandra Toney, Special Education Program Supervisor, OSPI

Cassie Martin, Executive Director of Special Education, OSPI

Kim Reykdal, Director of Graduation and Pathway Preparation, OSPI

Erin Furda, Biology/Algebra 1 IEP Case Manager at Sehome High School, Bellingham SD

Strand: Belonging & Inclusion

Audience: Superintendents, Principals, Secondary Asst. Principals, Central Offices

Learn How the Bethel District Developed a Principal Support Structure Focused on the Leadership Moves Required for Collaborative Cultures

302A

In our demanding and fast-paced world, it can be easy to neglect the development of our leaders, who must continuously shape a culture that promotes efficacy and collaboration. Strategies succeed when we create the space for the ongoing study of the principal leadership moves that develop key influencers, harden belief systems, and shape culture for true collaboration. Bethel has devised a replicable formula that organizes principals into learning teams for the ongoing study of this kind of leadership. Session attendees will learn about the importance and complexity of a continuous focus on leadership development. Attendees will also be prepared to emulate experiences that helped leaders design and facilitate leadership study sessions. Participants will also learn how the structure supports participant engagement, personal reflection, and application.

Kelley Boynton, Executive Director for Elementary Schools, Bethel SD

Strand: Culture

Audience: All

Whole Child, Whole School, Whole Community: the Why, How, and What

302B

Our journey began in 2018 when we recognized the importance of engaging our community to improve our practice in meeting the needs of all our children. We developed a long-range plan focused on the Whole Child, Whole School and Whole Community. Along the way, we learned about failing forward, finding ways to continue our progress through a levy failure and the COVID pandemic. We will share the systems that have supported our work.

Dana Rosenbach, Superintendent, North Mason SD

Lisa Roberts, Assistant Superintendent, North Mason SD

Amber Nygard, Assistant Director of Inclusive Learning, North Mason SD

Robert Kalahan, Principal, Hawkins Middle School, North Mason SD

Kyle Ehliis, Director of Inclusive Learning, North Mason SD

Strand: Systems & Operations

Audience: All

Three Leadership Tools for Your Comprehensive School Counseling Program

303A

The presence of a Comprehensive School Counseling Program (CSCP) is linked to an array of positive student outcomes including better attendance, a stronger sense of connection to school, improvement in learning behaviors, stronger math/reading scores, and improved postsecondary success. Hear administrators share success stories in using three free tools to prepare their CSCP staff for the coming year, collaboratively align the CSCP to school priorities, and build a better support system for ALL students!

Whitney Triplett, Executive Director, Hatching Results

Paul Meyer, Executive Director, Hatching Results

Kamrica Ary-Turner, Associate Director, AWSP

Strand: Systems & Operations

Audience: All

Strategies to Translate the Essential Elements of the Science of Reading into Instruction for ALL Students (ELL, Title/LAP, Special Education, Highly Capable)

303B

In this session, we will identify instructional approaches informed by the Science of Reading that will boost literacy performance and strengthen your district's Core ELA curriculum. Learn first-hand how districts in Washington state have accomplished this through incorporating Lexia LETRS professional learning for educators and Lexia Core5 Reading for their students.

MONDAY, JUNE 26

Lori Toth, Account Executive, Lexia Learning
Kelly Cloud, Account Executive, Lexia Learning

Strand: Academic Success

Audience: Superintendents, Principals, Elem. Asst. Principals, Central Office

Telling Your Financial Story

401A

What story do you want to tell the students, parents and taxpayers? Join Kris Grindy, Director of Business Services, for how to tell your financial story to the community. In uncertain times, it is critical that districts align the financial story to the student outcomes. Telling your sub-fund story assists with transparency with our communities and unions.

Kris Grindy, Director of Business Services, Washougal SD

Strand: Systems & Operations

Audience: Superintendents, Principals, Secondary Asst. Principals, Central Office

Are You an Aspiring Superintendent? We Have the Support You Need

401B

Wondering if the superintendency is a good fit for you? In this session you'll learn about the Aspiring Superintendent Academy, as well as additional supports WASA and ESDs are ready to provide! You'll be exposed to some of the insights and jumpstarts available to those who are interested in learning more about the role, individuals who've finished a superintendent certification program, and everyone in between. Current and former ASA participants, WASA staff and ESD leaders will be on hand to share and answer your questions.

Kim Casey, Superintendent, Soap Lake SD

Kim Fry, WASA Assistant Executive Director & ASA Facilitator

Larry Francios, Superintendent, ESD 189

Matthew Holshouser, ASA Member, Quillayute Valley SD

Michelle Price, Superintendent, NCESD

Michelle Suiter, ASA Member, Peninsula SD

Jessica Vavrus, Executive Director, AESD

Mark Westley, ASA Member, Adna SD

Andy Wolf, Assistant Executive Director, WASA

Strand: Innovation

Audience: Principals, Central Office

Establishing a Culture of Dignity and Belonging—Quantifying the Impact of our Efforts

401C

Too often, "equity" implementation reinforces a vicious cycle of failure largely because the keys to success are missing. This workshop makes actionable the key concepts of dignity, belonging and inclusion through a framework for districts, schools and educators who want to create the conditions for staff and students to thrive.

Omar Escalera, Executive Director of Equity, Partnerships, and

Family Engagement, Pasco SD

Strand: Belonging & Inclusion

Audience: Principals, Secondary Asst. Principals

Equity through Connection

402A

Don't let your master schedule be a barrier. Think creatively and use community resources, like tribal offices, local media, businesses, and law enforcement. Learn to invite with a purpose of making community connections. Embed intervention and enrichment into the schedule, build relationships, and tackle the attendance issues. We are a 100% poverty school that is taking steps to improve attendance and our graduation rate. Our journey continues and we want to share our steps and story.

Jennifer Tenney, Principal, White Swan High School, Mt. Adams SD

Curt Guaglianone, Superintendent, White Swan High School, Mt. Adams SD

Julie Schillreff, White Swan Community Liaison

Strand: Belonging & Inclusion

Audience: Principals, Secondary Asst. Principals

Transitional Kindergarten—Exploring Innovative Approaches to Serve our Youngest Learners

402B

The session will be highly engaging with attendees having an opportunity to share best practices with their transitional kindergarten programs and ask questions. OSPI staff will provide legislative updates, program updates, and share transitional kindergarten data. The goal is for all attendees to walk out of the session with a toolkit for success.

Jon Ram Mishra, Assistant Superintendent, Elementary, Early Learning, and Federal Programs, OSPI

Samantha Bowen, Executive Director, Early Learning, OSPI

Latisha Conley, Program Supervisor, Early Learning, OSPI

Strand: Academic Success

Audience: Superintendents, Principals, Elem. Asst. Principals, Central Office

How the Heck Does Special Education, 504, and MTSS Work Together???

402C

This is a pragmatic overview of how to design and align Special Education, 504, and MTSS systems to be the engine that creates inclusive learning systems in your schools. You will learn about the power you gain by having a deep understanding of the Exclusionary Factors of the Special Education Evaluation Process, the role of 504 with chronic absenteeism, and the power of the MTSS Process to establish Tier 1 classroom interventions and Tier 2 school-wide Interventions.

Nicholas French, Director of Teaching and Learning/Special Services/Federal Programs, Ocosta SD

MONDAY, JUNE 26

Holly Samuelson, Principal, Ocosta Elementary, Ocosta SD

Strand: Belonging & Inclusion

Audience: All

2:45 – 3:30 P.M.

EXHIBITS, ICE CREAM SOCIAL, AND PRIZE DRAWINGS

Location: Exhibit Hall A

Ice Cream Social sponsored by:



3:30 – 4:25 P.M.

CONCURRENT SESSION IV

Supporting the Well-Being of School-Level Staff Through Leadership

300A

This session will present research and strategies for school leaders to better understand how they can create a culture that ensures all teachers are well. Hanover will present research that outlines the ways in which leadership influences staff well-being and will provide examples and strategies that school and district leaders can use to support the well-being of staff in the 2023–24 school year.

Joel Aune, Executive Director, WASA

Leila Nuland, Senior Managing Director of K12 Research and Professional Services, Hanover Research

Strand: Culture

Audience: All

Inclusionary Practices to Promote Belonging

300B

This session will focus on research-informed indicators of inclusionary practices to support belonging and deepen learning opportunities for all students, including multilingual learners, students with disabilities, and students with complex needs. Participants will learn from exemplar schools and districts serving as demonstration sites for the Inclusionary Practices Project and MTSS implementation. Discussions will include actionable strategies for building community and overcoming resistors; tools and resources; and opportunities to plan next steps for your own system.

Tania May, Assistant Superintendent of Special Education, OSPI

Anna Marie Dufault, Assistant of Superintendent of Student Engagement and Support, OSPI

RJ Monton, Director of MTSS, OSPI

Strand: Belonging & Inclusion

Audience: All

AWSP Leadership Framework—The Student Growth Goal Journey and Alignment

300C

In this session, participants will have the opportunity to view a draft of the revised AWSP Leadership Framework student growth goals. Come and learn about these new revisions as well as the plan to collect feedback, how districts can pilot these new goals, and the timeline for implementation. Members of the state-wide workgroup will be present to answer any questions.

Jack Arend, Deputy Director, AWSP

Ann Gray, Associate Director, Educator Effectiveness, OSPI

Strand: Academic Success

Audience: All

Everyone Can Use Some R&R

300D

Hear one school's journey from exclusion to inclusion and the system we implement to support students' social-emotional needs. Reflect and Restore is a school-wide universal intervention that seeks to restore emotional regulation in secondary students, support teachers in maintaining teaching as a priority, and decrease the exclusion of students from class. Grounded in the principles of restorative justice and trauma-informed education, R&R has changed our middle school's response to student behavior.

Julie Shultz-Bartlett, Principal, Bethel Middle School, Bethel SD

Julia Muneshige, Assistant Principal, Bethel Middle School, Bethel SD

Ashley Swindahl, Social Worker/Family Resource Coordinator, Bethel SD

Strand: Belonging & Inclusion

Audience: Principals, Secondary Asst. Principals

Culture, Systems, and Learning: Where Everyone Belongs

302A

This presentation will give practical strategies to promote leadership with both staff and students focusing on culture, systems, and learning. Through being deliberate in this practice, the school has had academic success and student ownership of learning.

Shannon Leatherwood, Principal, Spanaway Middle School, Bethel SD

Kathleen Elkins, Assistant Principal, Spanaway Middle School, Bethel SD

Gretchen Herringshaw, Associate Administrator, Spanaway Middle School, Bethel SD

MONDAY, JUNE 26

Sharon Coward, Teacher, Spanaway Middle School, Bethel SD

Strand: Culture

Audience: Principals, Secondary Asst. Principals

Bites and Snacks! Maximizing Student Voice and Engagement in Schools!

302B

Maximize and augment student voice in your school! Learn AWSL's "bites and snacks" methods to grow, support, and sustain student engagement.

James Layman, Director, AWSL

Strand: Culture

Audience: All

Kick-Start Your Own Elementary Student Leadership Team

303A

Have you thought about building your own team of student leaders to champion a culture of positivity in your school? Not sure where to start or how to utilize them? Join us as we share the blueprint of the Davis Elementary FIRE Team. Five years in the making, we continue to build upon this team of fifth grade student leaders to impact the culture of our school. In this session, you will customize your own plan to create a team of student culture warriors for your site. Be inspired and get excited about forever changing the course of your school!

Chris Plucker, Assistant Principal, College Place PS

Mark Ferraro, Principal, Davis Elementary, College Place PS

Strand: Culture

Audience: Superintendents, Principals, Elem. Asst. Principals, Central Office

Implementing with Intention: A Student Growth Goal Learning Network

303B

How can districts create sustainable structures that support student growth? NEWESD 101 has convened a two-year learning network focused on intentional implementation of the revised Student Growth Goals. This learning network centers on OSPI's guiding principles, use of training modules, and exploration of Dr. Stembridge's text. We believe successful implementation goes beyond learning the content: it attends to stories and classroom practice to explore what works, for whom, and under what conditions.

Jennifer Ireland, Regional Literacy Coordinator and TPEP Lead, NEWESD 101

Steve Schreiner, Technology & Learning Coordinator, NEWESD 101

Strand: Academic Success

Audience: All

Creating a Culture of Belonging and Purpose for Each Learner

401A

Insights and lessons learned will be shared about our journey to create schools where each learner feels a strong sense of belonging and hope. We will discuss how we are supporting the social, emotional, and cognitive growth of our students, while elevating the professionalism and skills of our educators. We will provide details of culturally-responsive classrooms, student voice, morning meetings, inclusionary practices, MTSS, and PLC @ Work. We will also discuss the support and partnerships of WASA and AASA in our efforts.

Mary Templeton, Superintendent, Washougal SD

Aaron Hansen, Assistant Superintendent, Washougal SD

Strand: Belonging & Inclusion

Audience: Superintendents, Central Office

Reexamining Time: School-Life Balance

401B

As more schools across the country adopt modified school calendars to address the needs of their students, the adoption and implementation process can sometimes appear more difficult than it really is. This presentation will explore the current research on balanced calendars in the nation, the implementation process, and reflections from professionals who have gone through the process. Discussions will include insights into instructional practices, programmatic challenges, and community involvement with schools that have modified calendars.

David Hornak, Superintendent of Schools & Executive Director, National Association for Year-Round Education

James Pedersen, Superintendent, Essex County Schools of Technology

Jon Ram Mishra, Elementary Education, Early Learning, Special Programs and Federal Accountability, OSPI

Strand: Innovation

Audience: All

MONDAY, JUNE 26

WIAA as an Educational Partner

402A

WIAA provides education-based opportunities for all schools in the state of Washington. Research clearly supports an impressive positive impact to student participants' academic success. An investment in education-based activities helps keep students directly connected to their education and helps reduce other funding necessary for retention programs. This session will focus on the innovative practices of the WIAA to continue to increase participation and help support schools' activity directors. The WIAA is committed to supporting school personnel leading these programs while providing innovative solutions to help reduce the cost of the investment.

Mick Hoffman, Executive Director, WIAA

Doug Burge, Superintendent, Zillah SD

Strand: Academic Success

Audience: Superintendents, Principals, Secondary Asst. Principals, Central Office

Indigenous Success for Swinomish Students Attending La Conner Public Schools

402B

This presentation is based on 2022-23 Indigenous research in partnership with the Swinomish Indian Tribal Community (SITC) exploring what success is, how it differs from traditional success measures, and how it makes recommendations around success and measures of success for SITC students. This study could suggest similar research with other Native communities leading to similar recommendations for consideration in support of Native students and Native communities.

Will Nelson, Superintendent, La Conner SD

Strand: Culture

Audience: All

Regulate, Relate, and Reason: A Foundation for Success

402C

The job of a teacher is to reach a student's cortex. This presentation will show you a sequential way to engage the cortex for learning and problem solving. The content of this presentation can be applied to teaching students and working with staff and is the foundation of Dr. Bruce Perry's Neuro-sequential Model in Education.

Laura Ketcham-Duchow, Principal, Creekside Elementary, Mead SD

Nick Edwards, Principal, Mead Learning Options, Mead SD

Strand: Culture & Climate

Audience: Superintendents, Principals, Asst. Principals, Central Office, Admin. Interns

4:30 – 6:00 P.M.

WASA MEMBER PRESIDENT-ELECT CANDIDATES' RECEPTION

DT Salons I – IV Grand Ballroom

Sponsored by:



Beresford Company, Inc.
Quality Floor Coverings



TUESDAY, JUNE 27

6:15 – 7:00 A.M.

CONNECT AND REFLECT: A WALK IN THE PARK WITH OUTDOOR SCHOOLS WA

Location: Riverfront Park

Join Outdoor Schools WA for (another!) morning of self-care, connection, and reflection as we walk through the park. There will be prizes!



7:30 – 9:00 A.M.

CONFERENCE REGISTRATION

Location: Riverside Lobby

7:30 – 9:30 A.M.

CONFERENCE BOOK STORE

Location: Exhibit Hall A

Book store brought to you by *Hidden Spring Book Company*

7:30 – 9:30 A.M.

EXHIBITS AND COFFEE

Location: Exhibit Hall A

8:30 – 9:25 A.M.

CONCURRENT SESSION V

State Learning Standards Review Update

300A

OSPI staff will share the approach and status of the review and refinement of the state's learning standards. OSPI seeks to prioritize the learning standards with a lens of simplification, integration, and understandability. Attendees can inform the development of implementation support for districts including professional learning, instructional material guidance, and technical assistance.

Becky Wallace, Assistant Superintendent of Secondary Education and Pathway Preparation, OSPI

Jon Ram Mishra, Assistant Superintendent, Elementary, Early Learning, and Federal Programs, OSPI

Sue Anderson, Standards Project Review Co-Lead, Educator Growth and Development, OSPI

Shelly Milne, Director, Elementary Education, OSPI

Kara Todd, Standards Project Review Co-Lead, OSPI

Strand: Academic Success

Audience: All

Student Voice: Unlocking the Power of Student Agency Through Codesign

300B

Yakima Schools started with one question: "How do we guarantee authentic student voice that creates systemic improvements?" Rather than arbitrary focus groups, limited student board members, or narrow listening sessions, YSD focused on engaging students in reciprocal and authentic work. Students in Yakima authored, presented, and achieved approval of a district equity policy and drafted a first in the nation comprehensive student voice policy. Find out how at this session!

Marcello Sgambelluri, Equity Program Manager, Yakima SD

Trevor Greene, Superintendent, Yakima SD

Valeria Garza, Student, Yakima SD

Luanna Huang, Student, Yakima SD

Ezra Rottman, Student, Yakima SD

Andrea Ceballos, Student, Yakima SD

Conor Lincoln, Student, Western Washington University

Strand: Belonging & Inclusion

Audience: Superintendents, Principals, Secondary Asst. Principals, Central Office

Slowing the Game Down: Becoming More Intentional in Your Use of Time

300C

How do you organize time around what is important, engaging folks' strengths, interests, and needs to reconnect to the mission of the organization and working differently together? Grounded in the work of Powerless to Powerful, participants will review their current reality in relation to the four functions of administration and leave with an action plan that describes intentional behaviors focused on the work of developing a culture for learning for both students and adults.

Alexa Allman, Assistant Superintendent, Deer Park SD

Chuck Salina, Professor Emeritus, Gonzaga University

Suzann Girtz, Full Professor, Gonzaga University

Strand: Culture

Audience: All

2023 Legislative Recap

300D

This session provides an overview of the 2023 legislative session, a discussion of upcoming policy changes, and a look ahead to the 2024 legislative session. Come share your district and building stories, as well as your needs for the future.

Dan Steele, Assistant Executive Director for Government Relations, WASA

Strand: Systems & Operations

Audience: All

TUESDAY, JUNE 27

Split Personalities — When Two Elementary Schools Share an Associate Principal

302A

Many elementary schools have part-time associate principals who are split between two buildings. This presentation goes into detail about navigating that world and ensuring that both buildings run smoothly and effectively. This presentation also addresses how to keep the associate from just being a glorified dean of students and how to help them prepare to become a principal in the future.

Nick Davies, Associate Principal, Lake Shore/Eisenhower Elementaries, Vancouver PS

Anna Supplee, Principal, Lake Shore Elementary, Vancouver PS

Mark Jordan, Principal, Eisenhower Elementary, Vancouver PS

Strand: Systems & Operations

Audience: Superintendents, Principals, Elem. Asst. Principals, Central Office

From Exhaustion to Innovation: Increasing Improvement After Covid

302B

Covid both highlighted and magnified the diversity of student needs and the range of instruction that every teacher has to address. There is an opportunity to install innovative systems that work for all students. The Washington AIMS Project is a partnership between OSPI and the University of Washington Bothell that addresses the leadership capabilities for superintendents and other district and school administrators to implement a multi-tiered framework to support evidence-based instructional and assessments practices.

William Rasplia, Project Coordinator Washington AIMS, UW Bothell Goodlad Institute

Stephanie King, Executive Director Student Services, Marysville SD

Susan Ruby, Professor, Eastern Washington University

Tania May, Assistant Superintendent for Special Education, OSPI

Suzanne McKibbin, Director of Special Services, Deer Park SD

Haley Maxfield, MTSS Coordinator and Assistant Principal, Deer Park SD

Rebecca Lockhart, Executive Director of Student Services, Clarkston SD

Kindra Hibbard, School Psychologist, Clarkston SD

Strand: Academic Success

Audience: All

Using Strategic Scheduling to Improve CCR in Washington State

303A

A couple of years ago, the state Legislature passed the Academic Acceleration Policy. This effort was designed to improve CCR outcomes for students and to ensure all students were getting access to accelerated opportunities. AWSP, OSPI, and Abl have been working with 28 districts in Washington to support schools and districts in strategic scheduling. We will share statewide trends and best practices from across the state on how these districts have been leveraging one of their most important resources — the school schedule — to improve student learning and CCR outcomes.

Steven Gering, CAO in Residence, Abl Schools

Scott Friedman, Associate Director, AWSP

Strand: Academic Success

Audience: Superintendents, Principals, Secondary Asst. Principals, Central Office

Building Academic Success by Embracing Culture

303B

Culture is the heart of the K-12 program at Chief Leschi Schools. Learn how this focus drives our programs, building academic success, career and college readiness, and social emotional strength for all our students. Share about how culture is elevated at your school.

Jeannine Medvedich, Chief Academic Officer, Chief Leschi Schools

Nancy Nelson, CTE Director, Chief Leschi Schools

Strand: Culture

Audience: All

No Place for Hate Schools

401A

No Place for Hate is a collaborative initiative that provides Pre-K-12 schools with an organizing framework for students, administrators, teachers, and family members to develop long-term solutions for creating and maintaining an inclusive and equitable school climate. The No Place for Hate framework helps schools to: build inclusive and safe communities in which respect and equity are the goals and where all students can thrive; empower students, faculty, administration and family members to take action against bias and bullying by incorporating new and existing programs under one powerful message; and send a clear, unified message that all students have a place where they belong.

Laurie Lynch, Director of Education, Anti-Defamation League Pacific Northwest

Strand: Belonging & Inclusion

Audience: All

TUESDAY, JUNE 27

Principal Induction: Building a System to Grow, Support, and Sustain School Leadership

401B

Principal churn is a serious concern and new leaders are coming to leadership with less and less job experience through leadership programs and release time to learn the ropes in leadership. Come learn how two systems have worked with AWSP to assess their system's readiness for building a robust induction and mentoring program to support new leadership in your school system! The time to start is NOW!

Gina Yonts, Associate Director and Program Leader, AWSP

David Kennedy, Executive Director of School Improvement, Battle Ground SD

Mira Gobel, Assistant Superintendent of Schools & Social Emotional Learning, Pasco SD

Strand: Systems & Operations

Audience: All

Improving Student Outcomes Through Co-Teaching and Co-Planning Inclusive Service Delivery Model

401C

The IPP Demonstration Sites highlight how schools are creating transformational learning for visiting schools and districts. Demonstration sites are on their own path of continuous growth. Chase Middle School has reimagined service delivery for students and improved student outcomes. Through multi-year planning, Chase has created an inclusive service delivery model by expanding co-teaching/planning and co-assessing. Students once segregated are now included in their general education context and receive instruction on grade level core content.

Heather Chase, Principal, Chase Middle School, Spokane PS

RinaMarie Leon-Guerrero, IPP Demonstration Sites Project Lead, UW Haring Center

Mary Douthitt, Special Education Teacher, Chase Middle School, Spokane PS

Sue Rees, General Education Teacher, Chase Middle School, Spokane PS

Strand: Academic Success

Audience: All

The Intersection of Safety & Student Mental Health: Which Way do You Turn?

402A

In this session, learn how Bremerton School District did not have to choose a direction-sacrificing Safety for Mental Health or vice versa. By partnering with Gaggle, BSD has fortified its digital environments where students collaborate and communicate, learning valuable insights into student behaviors. BSD then turns those insights into action by referring students to Gaggle Therapy & Coaching, giving students flexible access to much-needed mental health services, removing roadblocks, and allowing students an expressway to support.

Jennifer Tripp, Regional Vice President, Gaggle

Iva Scott, Assistant Superintendent of Teaching and Learning, Bremerton SD

Patty Glaser, School Safety and Support Supervisor, Bremerton SD

Lee Baird, Regional Sales Manager, Gaggle

Strand: Belonging & Inclusion

Audience: All

Getting that Next Administrative Job You Really Want!

402B

This session will provide guidance, insight, and strategies for superintendents, District Office, and building administrators who are seeking their next administrative position. This session will provide a framework for professional educational administrators to develop a personalized, thoughtful approach to best seek a new position.

Thomas Rockefeller, CEO/Associate, Northwest Leadership Associates

Wayne Robertson, Associate, Northwest Leadership Associates

Mark Venn, Associate, Northwest Leadership Associates

Sergio Hernandez, Associate, Northwest Leadership Associates

Bill Jordan, Associate, Northwest Leadership Associates

Strand: Systems & Operations

Audience: All

Sustainability Planning and Carbon Benchmarking

402C

Bellingham PS is focused on sustainability planning which includes carbon benchmarking and the development of a district Sustainability and Resiliency Plan for embedding sustainability into all aspects of our organization. Our plan outlines three focus areas—facilities & operations, teaching & learning, and habits & culture—and identifies goals and measurable outcomes for each area. The carbon benchmarking allowed us to analyze our performance metrics, take a portfolio management perspective, and make future recommendations.

Jessica Sankey, Executive Director of Operations, Bellingham PS

Greg Baker, Superintendent, Bellingham PS

Mark Peterson, Director of Facilities & Sustainability, Bellingham PS

Gretchen Pflueger, Grant Writer & Special Projects Manager, Bellingham PS

Strand: Systems & Operations

Audience: All

TUESDAY, JUNE 27

9:30 – 11:15 A.M.

CLOSING BRUNCH, KEYNOTE, AND PRIZE DRAWINGS

Location: Exhibit Hall C

Janel Keating

Retired Superintendent, White River School District

Janel Keating is a recently-retired superintendent of the White River School District in Washington state. An educator with more than 30 years of experience, she is a former elementary and middle school teacher, elementary principal, director of student learning, and deputy superintendent. During her time as principal of Mountain Meadow Elementary, the school became one of the highest-performing elementary schools in the state. Janel is the recipient of the 2019 Robert J. Handy Most Effective Administrator Award in Washington.



Keynote sponsored by:



Prize drawing sponsored by:



11:15 A.M. – 12:00 P.M.

JANEL KEATING BOOK SIGNING

Location: Riverside Lobby

WASA and AWSP are here for
every stage of Your Career

NEW TO A POSITION

LAUNCHING SCHOOL
LEADERSHIP NETWORK
For New or Newly Assigned School Leaders



WASA EARLY CAREER
SUPERINTENDENT
ACADEMY

LEADERSHIP GROWTH



PREPARING FOR A NEW CHALLENGE



EXHIBITORS

Abl

610

Abl modernizes school scheduling & resource allocation to remove barriers to postsecondary success. Their software empowers educators to ensure time is well spent.

ACT, Inc.

527

ACT is a nonprofit organization providing a continuum of integrated assessment solutions that align with our mission of helping people achieve education and workplace success.

Advanced Classroom Technologies

319

We partner with educators to enhance their learning environments, stimulate creativity, and encourage collaboration and inclusivity. We empower today's learners with the technologies of tomorrow.

AESD Accreditation

220

AESD Accreditation is a research-based approach to school improvement aligned with the School Improvement Planning process, resulting in school accreditation for a period of six years.

American Reading Company

413

American Reading Company puts literacy at the center of school cultures. As a result, students read, write, research, and problem-solve at ever-increasing levels of proficiency.

Amplify

126

A pioneer in K-12 education since 2000, Amplify is leading the way in next-generation high-quality instructional materials and formative assessment. Visit amplify.com for more information.

Apollo Solutions Group

416

[*WASA Luncheon Sponsor*](#)

ASG is an Energy Service Company looking for energy savings in existing buildings. We do roofing, windows, lighting, HVAC, and even solar projects and we find ways to help secure funding as well.

Apptegy

216

[*WASA Corporate Partner*](#)

Make it easy to reach parents, students, staff, and your community: with Thrillshare, you can communicate better and influence how people feel about your schools.

Architects West

214

Architects West is a leading, award-winning, regional architecture, land planning, and interior design firm that has been specializing in the design of educational facilities for over four decades.

AVID

118

AVID partners with PK-12 districts and schools creating thriving learning cultures that activate student and educator agency, positively impacting opportunities and outcomes for every student.

Aya Healthcare

510

Aya Educational Services uses a digital-first approach to connect school districts and schools with the most qualified educators and healthcare professionals locally or throughout the country.

Beresford Company, Inc.

303

[*WASA President-Elect Reception Sponsor*](#)

[*WASA Corporate Partner*](#)

The Beresford Company delivers the highest quality products with the utmost level of integrity and expert service. Our success has been built on providing expert installations and professional consultation services with products which are easy to own and proven to reduce the cost of ownership.

Brainfuse

428

Founded in 1999, Brainfuse is America's premier online tutoring provider. With Brainfuse, students receive one-to-one tutoring via an easy-to-use online classroom, an industry-leading academic team, and over 4,000 Brainfuse-certified tutors nationwide. Learn more at www.brainfuse.com.

Braintrust Tutors

630

Braintrust Tutors is a company providing academic intervention to unique learners nationwide. We specialize in foundational math and literacy and are pioneers in the Science of Reading.

BuyBoard National Purchasing Cooperative

507

The BuyBoard National Purchasing Cooperative is a comprehensive purchasing tool for local governments to lessen the purchasing burden by driving down costs and making procurement more efficient.

EXHIBITORS

BYU Independent Study

110

While most virtual schools are just learning how to “do” online education, BYU Independent Study has offered online courses since 1996—that’s 25 years of online curriculum experience!

CENTEGIX

504

Our CrisisAlert system empowers teachers and administrators to act and respond with confidence in every situation, from the every day to the extreme.

Chartwells

418

[WASA Luncheon Sponsor](#)

[WASA Corporate Partner](#)

As an organization built on decades of food and education experience, we pride ourselves on serving food kids love to eat, giving students a voice, and creating programs to encourage fun, discovery, and participation. Our goal is to make students leave the cafeteria happier and healthier than they arrived.

City University of Seattle

316

[AWSP Business Partner](#)

City U is one of the Northwest’s largest private not-for-profit universities with more than 40,000 graduates worldwide. For more than 30 years, City U has helped people change their lives by providing quality education in the most convenient manner possible.

Clear Risk Solutions

307

[WASA Luncheon Sponsor](#)

[WASA Corporate Partner](#)

Clear Risk Solutions specializes in insurance program administration and risk management services.

Clear Touch

620

Clear Touch® is a forward-thinking technology provider named to the Inc. 500 list of the fastest-growing companies and recognized as one of South Carolina’s 25 Fastest Growing Companies. U.S.-owned and operated, Clear Touch® develops products for education, business, and government including multi-touch interactive panels, software suites, and accessories.

Cognia

311

[WASA Luncheon Sponsor](#)

[WASA Corporate Partner](#)

Cognia is a global network that offers a holistic approach to continuous improvement, encompassing accreditation, certification, assessment, professional learning, and improvement solutions.

College Board

402

[WASA Luncheon Sponsor](#)

[WASA Corporate Partner](#)

Each year, the College Board helps more than seven million students prepare for a successful transition to college through programs and services in college readiness and college success—including the SAT and the Advanced Placement Program. The organization also serves the education community through research and advocacy on behalf of students, educators and schools.

Corebridge Financial

426

Corebridge Financial (formerly AIG Retirement Services) is the leading retirement plan provider for K–12 schools. Our goal is to make retirement planning accessible for all school employees.

Curriculum Associates

517, 519

[Sponsor of Keynote Steve Pemberton](#)

[WASA Luncheon Sponsor](#)

[WASA Corporate Partner](#)

Curriculum Associates designs research-based, teacher-acclaimed products that provide classrooms with flexible resources that deliver meaningful assessments and data-driven, differentiated instruction.

Cybersecurity and Infrastructure Security Agency

427

As the nation’s cyber defense agency, CISA stands ready to help organizations prepare for, respond to, and mitigate the impact of cyberattacks.

Demco

222

Demco maximizes positive outcomes for all learners by offering inspired solutions. Demco provides supplies, equipment, and furniture to schools and libraries to equip, engage, and empower learners.

DreamBox Learning

423

DreamBox Learning® provides effective and engaging math, reading, and professional development solutions that have been independently shown to accelerate student learning achievement.

Eastern Washington University

119

An NACEP accredited program.

EXHIBITORS

Edmentum

325
Digital Curriculum/Assessments/Educational Consulting.

Edupoint Educational Systems

115
Synergy Education Platform by Edupoint Educational Systems is an industry-leading student information and learning management ecosystem for K–12, serving five million students in 22 states.

Ellevation

521
Sponsor of Keynote Steve Pemberton
Ellevation is the nation's leading K–12 software solution for multilingual learners and the educators who serve them.

Embark Behavioral Health

326
Embark Behavioral Health is a leading nationwide network of outpatient centers and residential programs offering premier mental health treatment for preteens, teens, and young adults.

Embrace Education

618
Empowering special education instructors with easy-to-use, high-quality software for IEP, MTSS, 504, Medicaid billing, and more, all combined with exceptional customer service—that's Embrace®.

EPS/School Specialty

116
Proven supplemental, PK–12 ELA & math solutions that promote achievement & equitable education for all students. Interventions & assessment materials like S.P.I.R.E.®, Coach®, Wordly Wise® & more!

Equitable Advisors, LLC

409
Equitable provides financial products and services that are designed to meet the unique needs of educators and staff in K–12 public schools. Our team specializes in preparing clients for retirement.

EVERFI

327
Join the 60,000+ teachers who used EVERFI's NO-COST award-winning lessons this past school year! Interactive, game-based lessons designed by experienced educators help you engage students at all grade levels and bring real-world skills to your classroom.

EWU Principal Certification Coordinator

227
NACEP Accredited Concurrent Enrollment Program.

Formative

508
Formative is an all-in-one platform that combines instruction and assessment. It transforms classroom activities into standards-aligned, real-time assessments that generates data to drive instruction.

Gaggle

315
WASA Luncheon Sponsor
WASA Corporate Partner
Gaggle is the pioneer in helping K–12 districts manage student safety on school-provided technology. Our mission is to help ensure the safety and well-being of all students.

Gallagher VEBA

304
AWSP Business Partner
WASA Corporate Partner
VEBA is a non-profit, tax-exempt trust that provides a health reimbursement arrangement (HRA) founded in 1984 by WASA, AWSP, and WASBO.

Gonzaga University

512
Gonzaga University — Graduate Enrollment Management and the School of Education.

Graduation Alliance

612
Graduation Alliance gives schools and communities resources and support to help individuals reach their educational and career goals through alternative education and workforce training programs.

Grand Canyon University

424
Sponsor of Keynote Janel Keating
WASA Corporate Partner
Grand Canyon University is Arizona's premier, private Christian university. GCU provides affordable, transformative higher education and is dedicated to serving students, the community, and the greater good. GCU's nine distinct colleges offer more than 200 academic programs, including over 150 online programs.

EXHIBITORS

Hanover Research

302

WASA Corporate Partner

Leadership, Professional Learning, Consultation, and More for School Counselors, Administrators, and District Leaders.

Heritage University Educational Administration

309

AWSP Business Partner

Heritage University Leaders for Lasting Impact (L2I): Principal and Program Administrator Certification Program.

Horace Mann Companies

202

AWSP Business Partner

Founded in 1945, Horace Mann offers affordable auto and home insurance, as well as retirement strategies and financial wellness education.

Kaiser Permanente

408

AWSP Business Partner

Kaiser Permanente exists to provide high-quality, affordable health care services and to improve the health of our members and the communities we serve.

KCDA

317

KCDA provides centralized procurement services to member school districts and public agencies. They save time and money and complies with legal procurement requirements.

Kid Spark Education

622

Kid Spark Education is a nonprofit organization whose mission is to help all children, especially those from underserved and underrepresented communities, to learn and love STEM.

KinderCare Learning Companies

414

More than just a before- and after-school program, Champions is a true community partner for schools and hardworking families. Learn more at www.discoverchampions.com.

Kognity

425

Your Digital Resource for High School Science. Kognity for High School Science provides three-dimensional learning with a balance of digital and non-digital opportunities to collaborate and explore.

Kuder

112

Kuder partners with school districts to provide a configurable, research-based college and career readiness platform that confidently guides students through each stage of the career planning process.

Lee & Low Books

215

As an independent and minority-owned publisher, Lee & Low Books has specialized in culturally responsive diverse stories for over 30 years. We make books "About Everyone, For Everyone" for all ages.

Lexia Learning

410

AWSP Business Partner

Across all our solutions and services, Lexia's approach is focused on sound methodology, engaging experiences, and continued acknowledgement of the value of each individual learner. By doing so, we're making literacy truly accessible for everyone we support.

Lightspeed Technologies

122

Lightspeed Technologies offers instructional audio solutions for the whole classroom, distance learning applications, and small groups.

Maxim Staffing

225

Since 1988, in response to a national nursing shortage, Maxim Staffing has connected the nation's top talent to a variety of healthcare partners. We specialize in creating meaningful career opportunities for medical professionals including nurses, allied health professionals, locum tenens, travel nurses, medical coders, and more.

McKinstry

305

WASA President-Elect Reception Sponsor

WASA Corporate Partner

We are problem solvers compelled by our vision, mission and values to eliminate barriers standing in the way of a better built environment that serves our people, clients, and communities.

MENTOR Washington

405

MENTOR Washington promotes, supports, and expands quality youth mentoring that fosters positive youth development, academic success, and job and career readiness.

EXHIBITORS

Milliken

201

[WASA Luncheon Sponsor](#)

[WASA Corporate Partner](#)

We focus on insights and innovation to develop everything from new molecules to new products that protect first responders, help wounds heal faster, protect our food, and make environments healthier.

Motorola Solutions

624

Motorola Solutions is a global leader in public safety and enterprise security.

NatureBridge

528

Our mission is to connect young people to the wonder and science of the natural world, igniting self-discovery and inspiring stewardship of our planet. Through our overnight, hands-on environmental science programs, we take more than 35,000 children and teens each year into our national parks to explore the outdoors, connect with their peers, discover themselves, and develop a lasting relationship with the environment.

New Haven RTC

226

New Haven was created in 1995 to provide a safe, comforting, home-like environment for adolescent girls who need a safe place to get better.

Newsela

406

[WASA Luncheon Sponsor](#)

Flexible, engaging and standards-aligned content and instructional supports for Washington students.

Northwest Textbook Depository

217

Northwest Textbook Depository (NWTB) serves as your one-stop resource for K-12 instructional materials. We make ordering easy.

Northwest Leadership Associates

321

Northwest Leadership Associates assist local school districts in recruiting, screening, and selecting new superintendents and other school system leaders and provide educational consultant services.

OAC Services

200

[Golf Tournament Sponsor](#)

[WASA Luncheon Sponsor](#)

[WASA Corporate Partner](#)

OAC EDU is the region's premier education program and project management firm. OAC EDU partners with school districts by offering a full range of services, from pre-bond planning through project closeout and warranty management.

Office of Superintendent of Public Instruction, Professional Certification Department

212, 523

[WASA Partner](#)

Office of Superintendent of Public Instruction — Professional Certification Department.

Only7Seconds

223

Only7Seconds is on a mission to end loneliness for youth! We provide resources and programming to help youth build meaningful connection, feel less lonely, and support others who are lonely.

Pearson Virtual Schools

515

[WASA Luncheon Sponsor](#)

[WASA Corporate Partner](#)

Pearson Virtual Schools supports K-12 school leaders with a full range of high-quality, full-time online learning solutions to meet the individual needs of their students..

PGLS

124

PGLS is a leading provider of comprehensive multilingual Translation, Interpretation, and Language Training solutions in over 200 languages and dialects.

Powerschool

218

As the leading provider of cloud-based software in K-12 education, we connect students, teachers, administrators, and parents with the shared goal of improving student outcomes.

Promethean

429

Promethean makes interactive displays and teaching software that drive breakthroughs for teachers, students, and colleagues around the world.

EXHIBITORS

Really Great Reading

125

Really Great Reading® is a pioneer in evidence-based reading instruction, providing instructional materials that help students develop foundational reading skills. Avoid special education referrals; explore our engaging, evidence-based, foundational reading instruction and interventions; address comprehension issues using a revolutionary vocabulary approach; and jumpstart student outcomes across the curriculum.

Renaissance

524, 526

[WASA Luncheon Sponsor](#)

[WASA Corporate Partner](#)

Since 1986, our mission has remained the same: to accelerate learning for all children and adults of all ability levels and ethnic and social backgrounds, worldwide.

Rentacrate Enterprises, LLC

509

But for a child and a teacher, I would not have a job. School moves are stressful. Let Rentacrate's School Moving division make your move easier on you and your teachers.

Retirement Nationwide, Inc.

608

[Ice Cream Social Sponsor](#)

We work with WSTRS members and help them navigate and plan their Pension Options.

Right At School

203

[WASA Luncheon Sponsor](#)

[WASA Corporate Partner](#)

Right At School provides high-quality before and after school enrichment programs with a mission to inspire a love of learning, support schools, and give parents peace of mind.

Savvas Learning Company

511

At Savvas, we believe learning should inspire. Our next-generation K-12 learning solutions engage students and empower teachers, helping all learners discover their greatness. Visit www.savvas.com.

Scanning Pens Inc.

318

Scanning Pens strives to embed a life-long love of reading for all individuals. The C-Pen Reader 2 is the next generation assistive technology tool. Free school trials available!

SchoolData.net

123

Introducing SchoolData.net Connect, the singular experience that offers districts improved analytics, easier adoption, and fast, frictionless access to the student data that makes a difference.

Seattle Pacific University

204

[AWSP Business Partner](#)

For more than 100 years, Seattle Pacific University has been training educators of competence and character. SPU's NCATE-accredited School of Education offers 12 graduate degree and professional certification programs, including several delivered at off-campus sites in western Washington.

Sibme

407

Sibme embeds practice and collaboration in every workday, engaging educators while building a stronger community through our professional learning engagement platform and virtual coaching services.

SmartLab

323

SmartLab® integrates STEAM curriculum, PBL, world-class PD, and technology to engage students in hands-on learning.

Sodexo

219

Sodexo is a professional food service and facilities management provider. Through wholesome nutrition and healthy buildings and grounds, Sodexo helps build strong, resilient learning communities.

Solution Tree

404

[WASA Corporate Partner](#)

Each of our solutions is built on research-based processes to support your staff, confront essential challenges, and foster sustainable change.

Special Olympics Washington

628

The Special Olympics Unified Champion Schools program is aimed at promoting social inclusion through intentionally planned and implemented activities affecting systems-wide change.

EXHIBITORS

Spokane Virtual Learning

513

Spokane Virtual Learning, a program of Spokane Public Schools, helps other public school districts provide their own high-quality online learning program with no upfront costs or loss of FTE.

Sunrise RTC

324

Sunrise RTC is a long-term, fully-adherent Dialectical Behavior Therapy residential program for adolescent girls. Sunrise uses ongoing assessment to provide outcome-informed treatment individualized for each students' needs. Throughout their stay at Sunrise, students are enrolled in full-time, accredited schooling and engaged in community-based activities.

TalkingPoints

120

[WASA Luncheon Sponsor](#)

[WASA Corporate Partner](#)

TalkingPoints is an education technology nonprofit with a mission to drive student success by using accessible technology to unlock the potential of family engagement in children's education.

The Princeton Review and Tutor.com

529

Tutor.com & The Princeton Review® partner with K-12 schools to provide 24/7, no-cost, 1-to-1 tutoring and homework help in 250+ subjects.

The Track Dr.

322

ThoughtExchange

412

[WASA Luncheon Sponsor](#)

[WASA Corporate Partner](#)

Thousands of leaders are gaining insights and bringing millions of people together in the business, public, and education sectors using ThoughtExchange.

University of Washington Leadership for Learning (EdD) Program

127

L4L serves leaders committed to transforming systems towards educational justice. Rigorous job-embedded learning leads to EdD & optional superintendent credential. Recruiting now for our 2024 cohort.

VariQuest

522

VariQuest helps teachers and administrators to better educate, motivate, and communicate with students and staff with our school friendly Poster Makers, Digital Cutout Makers, and Cold Laminators.

Virco, Inc.

221

Since 1950, Virco has proudly manufactured industry-leading furniture and equipment for K-12 schools in the US. Collections include seating for healthy movement; technology-ready tables, and a range of collaborative tables, and desks for flexible classrooms.

Washington College Savings Plans - WA529

614

Learn about Washington's 529 Education Savings Plans (WA529), the Guaranteed Education Tuition Program, and the DreamAhead Investment Plan at 529.wa.gov.

Washington Department of Health

224

The Department of Health works with others to protect and improve the health of all people in Washington state. The Washington State Department of Health (DOH) fights to defend the public's health from threats in a rapidly evolving world. DOH's programs and services, implemented in collaboration with local health departments and state, federal and private partners, touch the lives of all Washingtonians and visitors to the state 24 hours a day, 7 days a week.

Washington DSB Pre-Employment Transition Services

616

DSB Pre-ETS offers free support to schools and districts, helping ensure students with visual disabilities receive the services needed to meet their HSBP and IEP goals using WIOA mandated resources.

Washington State Alliance of YMCAs

525

[Sponsor of the Luis Cruz Keynote](#)

The YMCA is the largest provider of child care in WA. Ys partner with schools & families to serve more than 139,000 youth in Early Education, Before & After School Enrichment Programs, and Camps.

EXHIBITORS

Washington State University

411

Washington State University, with campuses in Pullman, Spokane, Tri-Cities and Vancouver, provides quality degree and certification programs in Educational Leadership.

Western Governors University

117

A degree that moves you forward—a cost that won't hold you back.

Western Washington University Education Leadership

121

Woodring College of Education facilitates life-long learning through exemplary teaching to prepare quality education, health, and human services professionals for democratic citizenship and meaningful careers.

Workpointe - Education Furniture

421

Workpointe is a family owned business that has been servicing our education clients for over 40 years with their furniture needs. We offer space planning, design, and proud member of KCDA Contract!

WSIPC

420

[WASA Luncheon Sponsor](#)

[WASA Corporate Partner](#)

The Washington School Information Processing Cooperative provides comprehensive, relevant, and fiscally responsible technology products, highlighted by Skyward Education Management System, services & support to the K-12 community.

WSRMP

313

[WASA Luncheon Sponsor](#)

[WASA Corporate Partner](#)

The Washington Schools Risk Management Pool (WSRMP) is a self-funded, non-profit risk pool existing in partnership with its members to provide their staff and student communities a safe and protected educational environment, while protecting member resources.

VapeDetect

506

VapeDetect provides fast and reliable vape detection for school bathrooms. It's the only hidden vape detector and can detect vaping in real time with instant alerts via text, app, or email.

Zaner-Bloser

114

Zaner-Bloser is a literacy company focused on the K-5 foundational skills that are the essential elements of teaching and learning.

THANK YOU TO
OUR AMAZING
EXHIBITORS!



EXHIBITOR MAP

2023 SUMMER CONFERENCE EXHIBIT HALL MAP

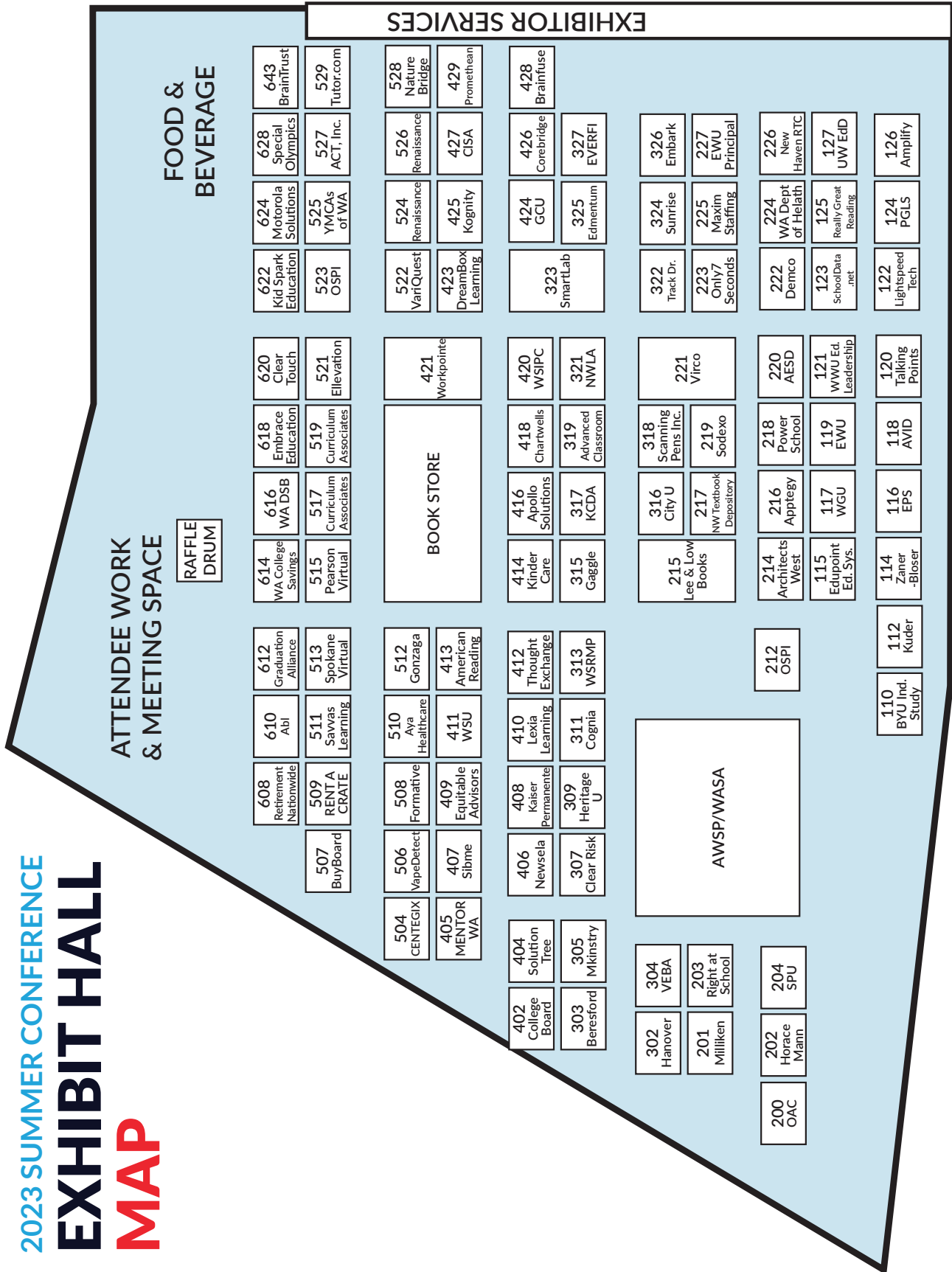

FACILITY MAPS

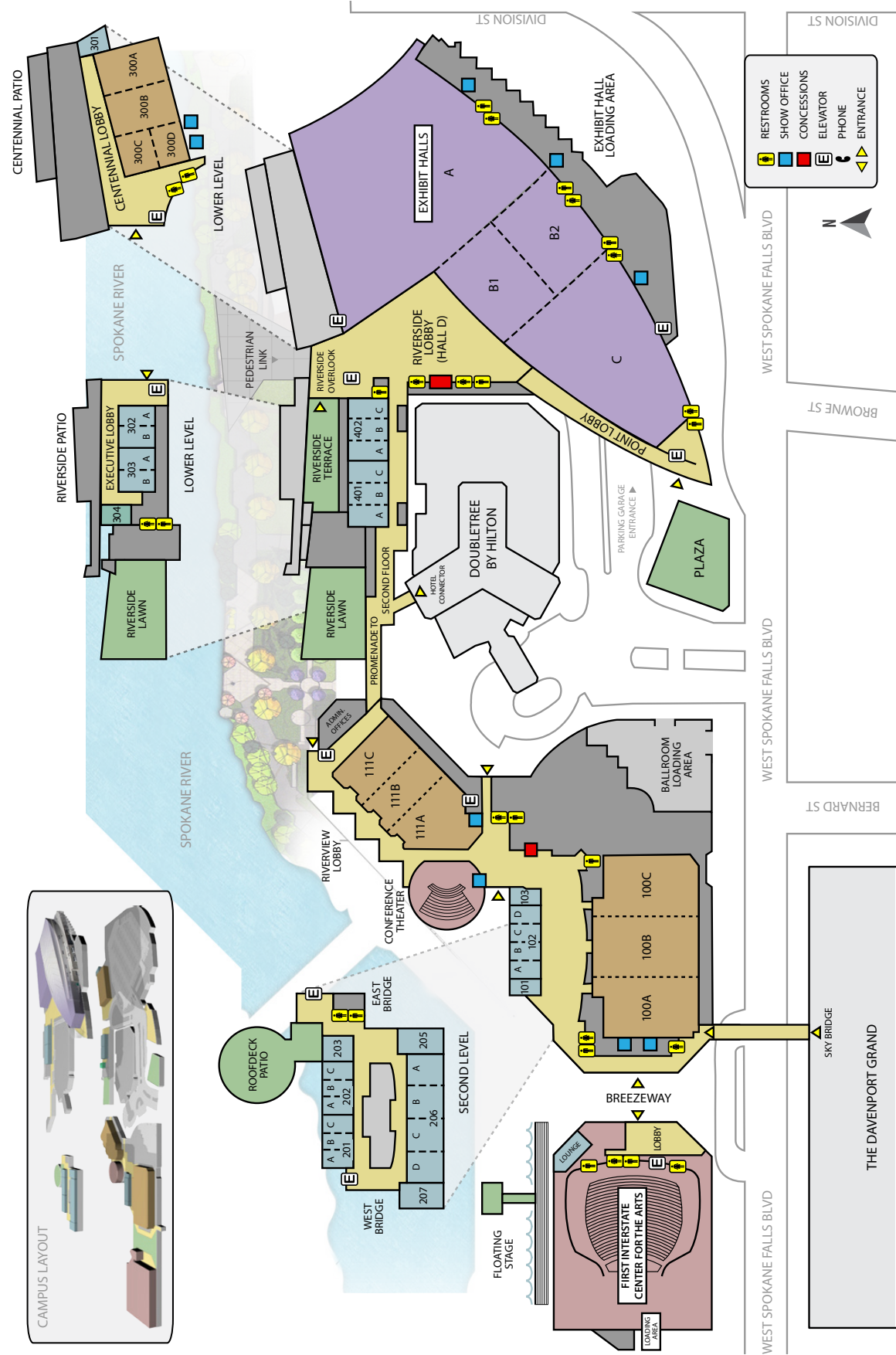

FACILITY MAPS

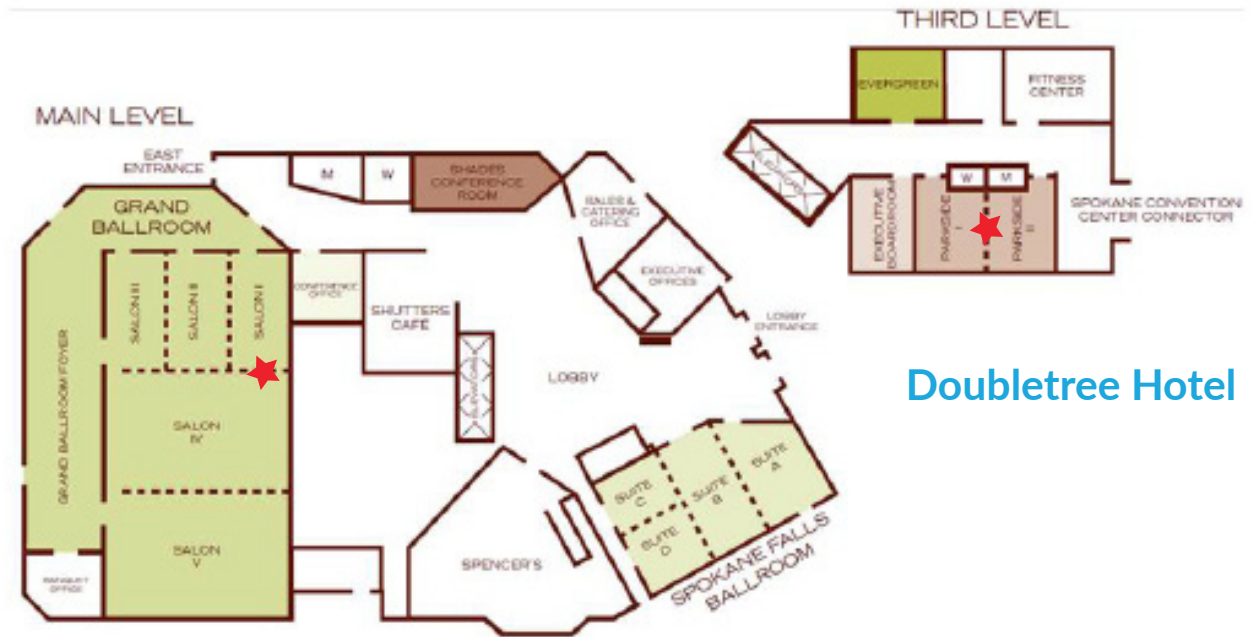

Doubletree Hotel

Grand Hotel

